

(109)  
 State of S<sup>c</sup> Carolina Pursuant to a warrant  
 from John Thomas Esq<sup>r</sup> Com<sup>r</sup> of locations Dated 20<sup>th</sup> May 1790  
 I have admeasured & laid out unto John Matlow a tract  
 of one hundred and forty six acres of land in  
 Greenville County on the E. side of Saluda river -  
 Bounded by a line running E<sup>t</sup> by land laid out for  
 Alex<sup>r</sup> M<sup>r</sup> Elheney, by lines running S<sup>76</sup> E<sup>84</sup> & S<sup>84</sup> E<sup>76</sup>  
 by land laid out for Hooper, by a line running S<sup>85</sup> W<sup>5</sup>  
 by land laid out for Hugh Lewis, W<sup>1</sup> on Saluda river  
 and hath such and Marks as the above Plat represents

Surveyed 29<sup>th</sup> May 1790, George Salmon  
 Recorded 26<sup>th</sup> June 1790, Det. self



South Carolina } Pursuant to a warrant from  
 Laurens County } John Thomas Esq<sup>r</sup> Com<sup>r</sup> of locations  
 96 District N<sup>c</sup> Saluda. Dated  
 26<sup>th</sup> March 1789, I have admeasured and laid  
 out unto Archibald Melarg, a tract of 287 1/2  
 acres of land situated in said district on  
 a branch called Mountain-Creek the waters  
 of Keburns Creek, bounding S<sup>c</sup> on land not  
 known, N<sup>e</sup> on South Johnson & East on Joseph  
 Downs, and hath such shape and Marks  
 as the above Plat represents.

Surveyed 20<sup>th</sup> March 1790,  
 John Rodgers D<sup>r</sup>  
 Recorded 9<sup>th</sup> July 1790, Det. self

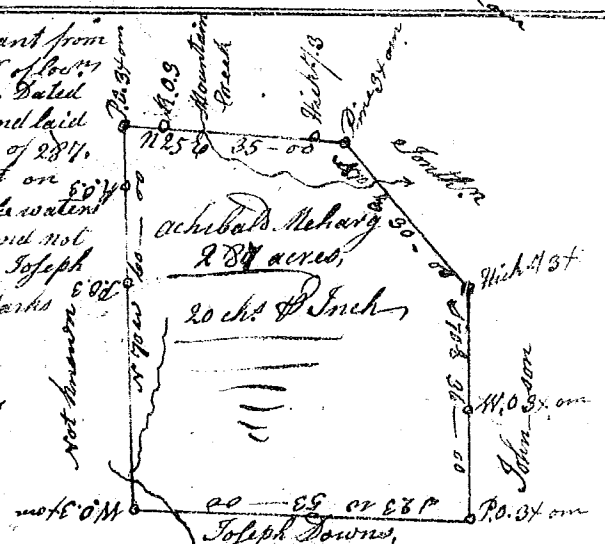

South Carolina } Pursuant to a warrant from  
 Laurens County } John Thomas Esq<sup>r</sup> Commissioner  
 of locations in 96 District N<sup>c</sup> Saluda, I have  
 admeasured and laid out unto Thomas Ship  
 a tract of one hundred & eighty four acres of  
 land in said District lying on a branch  
 called Beaver-dam the waters of both rivers  
 of Saluda, bounding by a line running S<sup>82</sup> E<sup>18</sup>  
 Rich<sup>d</sup> Towels S<sup>c</sup> on a line running S<sup>82</sup> W<sup>8</sup>  
 wharriors N<sup>e</sup> on a line of Archibald Melarg, the other  
 Lines Not known, and hath such form and  
 Marks shape & Marks as the above Plat represents

Surveyed the 9<sup>th</sup> May 1790  
 Recorded 27<sup>th</sup> July 1790, Det. self  
 by John Rodgers D<sup>r</sup>

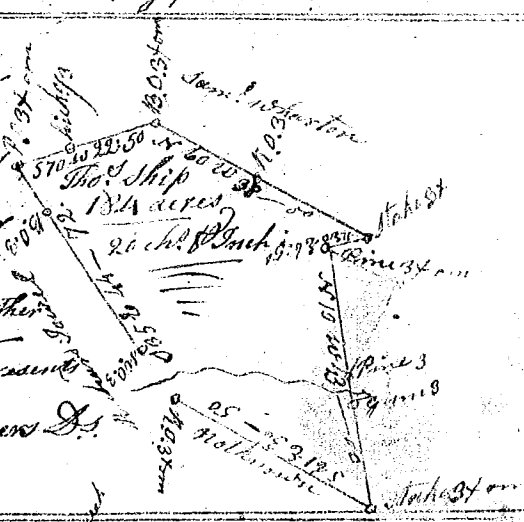

State of S<sup>c</sup> Carolina Pursuant to a warrant  
 from John Thomas Esq<sup>r</sup> Commissioner of locations  
 96 District N<sup>c</sup> Saluda River, I have admeasured &  
 laid out unto James Greer a tract of one  
 hundred & eight acres of land on Duncan's  
 Creek in Laurens County beginning at a stake on  
 the bank of Duncan's Creek, thence or running with Robert  
 McCrearys line S<sup>20</sup> W<sup>10</sup> and hath such shape Marks  
 callings and boundings as the above Plat represents

Surveyed 26<sup>th</sup> June 1790,  
 Recorded 3<sup>rd</sup> Sept 1790, sent to Robt Warren

